

Machines	Axes	Equipment (Varies depending on machine and aggregate)			Surface 180°	Corner 90°	Center wall 90°	Miter 22.5° – 180°
Portal	3/4		—	1 × P-System cutter 1 × cutter arbor 1 × drill Ø 6 mm				
				2 × P-System cutter (2) × cutter arbor 1 × drill Ø 6 mm				
				1 × P-System cutter 1 × cutter arbor 1 × P-System drill Ø 6 mm				
	4			1 × P-System cutter + adaptor 1 × P-System drill Ø 6 mm + adaptor				
	5		—	1 × P-System cutter 1 × cutter arbor 1 × P-System drill Ø 6 mm				
				2 × P-System cutter (2) × P-System cutter arbor 1 × P-System drill Ø 6 mm				
Nesting	3/4	—	—	1 × drill Ø 5 mm 1 × drill Ø 6 mm				
	5		—	1 × P-System cutter 1 × cutter arbor 1 × P-System drill Ø 6 mm				

- Possible
- Only possible with Zeta P2 and positioning pins

**Tip:** Instead of using an angle aggregate, the Zeta P2 power tool can be used to cut the P-System groove in the center of the surface. To do so, drill two 5 mm positioning holes spaced at 101 mm in the workpiece's surface using the CNC router. These are required to align the Zeta P2 on the workpiece.

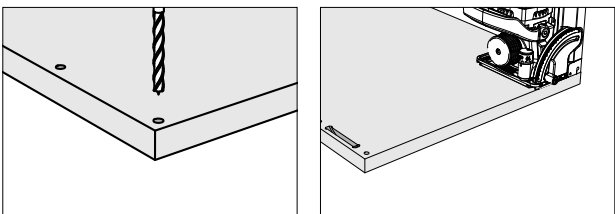

Possible with shaft tool

Not possible