



# Tips Tricks

Connect dividing panels from 16 mm with the Tenso P-10 and the P-System depth adjuster cap 4 mm for P-8



Would you like to **join thin materials?** Using the P-System depth adjuster cap 4mm to offset the element you can connect dividing panels with a material thickness of 16 mm and greater

## How it works:



1. Mark the work pieces

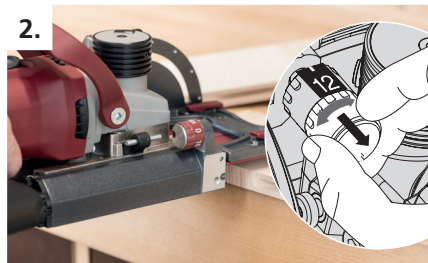

2. Cut a groove into the edge with the 2 mm spacer (groove depth 12 mm)

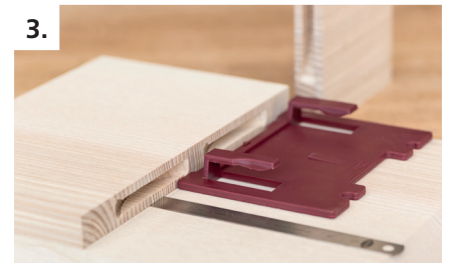

3. Align shelf as stop in offset position using the 2 mm spacer



4. Attach the P-System depth adjuster cap 4 mm for P-8 (groove depth 8 mm)



5. Cut groove into the surface



6. Insert the connector



7. Preload the Tenso P-10



8. Apply glue



9. Connect... Finished!

# P-System

Form-locking anchorage  
without tools

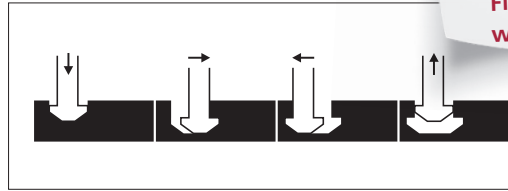

**Tips  tricks**  
Find the right P-System connector  
with the configurator



# Clamex P

Detachable connecting fitting

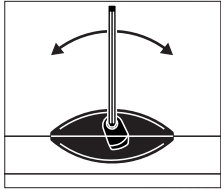

Detachable

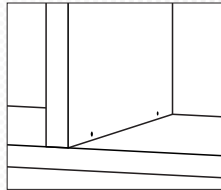

Aesthetic

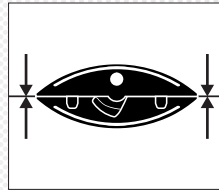

High clamping  
force

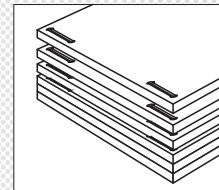

Stackable

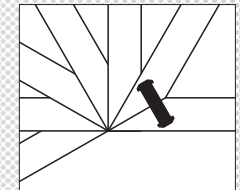

Versatile

# Tenso P

with preload clip, self-clamping fitting as  
glueing aid, for all angles

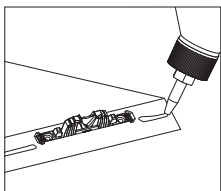

Glueing

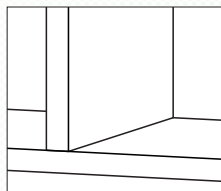

Invisible

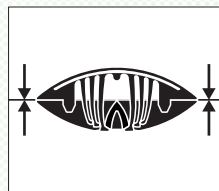

High clamping  
force

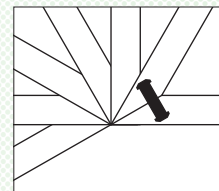

Versatile

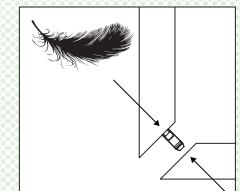

Lower assembly  
force

# Divario P

Self-clamping, invisible fitting for slide insertion

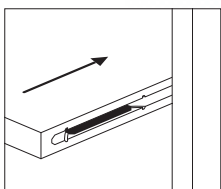

Sliding insertion

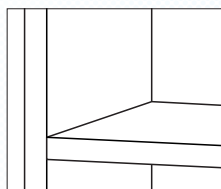

Invisible

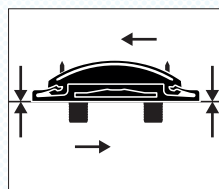

Clamped joint

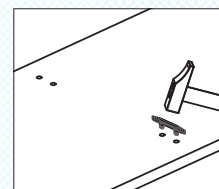

Fast installation

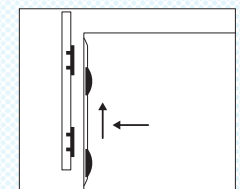

Assemble by sliding



Manufacturer:  
**Lamello AG**  
Joining technology  
Hauptstrasse 149  
CH-4416 Bubendorf  
Tel. +41 61 935 36 36  
Fax +41 61 935 36 06  
info@lamello.com  
www.lamello.com